

# SAFETY KNIFE

## SECUMAX 150

ORDER NOW!

Order No.	150001.12
Knife size (L x W x H)	148 x 11 x 37.2 mm
Weight knife	26.0 g
Basic material	Recycled plastic, glass fibre reinforced



MAXIMUM  
SAFETY



**Concealed blade**  
for maximum protection of  
users and goods

**Innovative 3-in1  
blade head**  
for cutting, scraping  
and splitting

**Light ergonomic handle**  
for right and left handers

**6 mm cutting depth**  
for all common cutting  
materials



**Guide surfaces**  
for easier diagonal cutting

**2-cutting edge blade  
(not changeable)**  
for a double period of use

**Sustainable handle**  
made from at least 80 %  
recycled plastic plus fibreglass  
reinforcement

THE SAFER WAY TO CUT.

**martor**

# MARTOR SAFETY KNIFE SECUMAX 150



## SAFETY TECHNOLOGY



**SECUMAX**  
= maximum safety

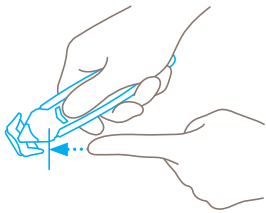

**Concealed blade**  
The SECUMAX 150 blade is not an open one, but is hidden from people and goods. This provides you with a maximum degree of safety from cut injuries and from damage to goods.

## TECHNICAL FEATURES



Disposable knife



Abrasion resistant



Very ergonomic



2-cutting edge blade



Cutting depth



Scraper width



Tape splitter



For right and left handers



Lanyard hole



Printable for promotional purposes

## EXAMPLES OF USE



## MAIN CUTTING MATERIALS



Cardboard: up to 2-ply



Wrapping, stretch and shrink foil



Tape



Plastic strapping band



Bagged goods



Layers of foil or paper



Yarn, cord



Felt

## MOUNTABLE BLADES

The blade is moulded into the body of the knife and cannot be changed.  
Blade thickness 0.30 mm.

## PACKING INFORMATION

Packaging unit	10 in box (loose)
Size Single unit box	154 x 113 x 40 mm
Weight single unit box	283.0 g
EAN Code single unit box	4002632972133