

SECUMAX 350 SE

ROBUST, SUSTAINABLE, SAFE? ABSOLUTELY!

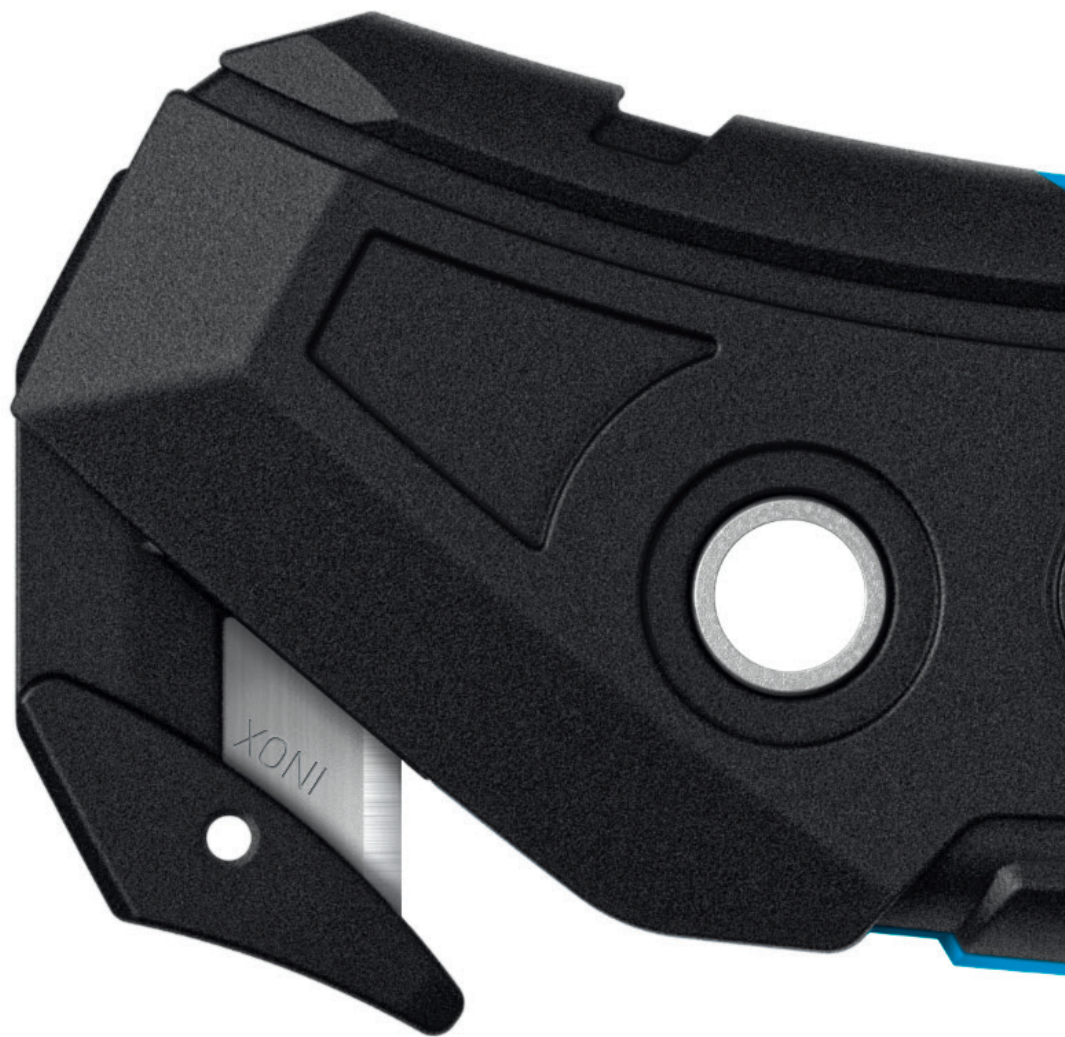

THE SAFER WAY TO CUT.

martor

SECUMAX 350 SE
NO. 350145



Original size



Robust and stainless
The plastic-covered blade head is particularly robust with a blade thickness of 0.5 mm. It is also rust-proof, making it ideal for use in damp conditions, e.g., cutting cellulose-fibre materials.



Concealed blade
The blade head's two cutting edges are safely concealed to protect users and goods and are yet capable of safely cutting 2-ply cardboard boxes and much more.



Spare blade in storage
Changing the stainless steel blade is easily and safely executed. Look for the arrow and follow its lead. Open the blue inner side of the knife to reveal the spare blade while also releasing the locking mechanism of the robust blade head.



Ergonomically shaped
Right handed or left handed? It's really all the same. The SECUMAX 350 SE fits perfectly in any hand. Gently arched outer edges, coupled with light ribbing make for an ergonomic experience.



Sustainably designed
MARTOR prioritises sustainability. SECUMAX 350 SE's handle is made of a high-quality recycled plastic. To enable future recycling, it does not use soft-grip components.

More sustainability for cutting tasks? Try it yourself. With robust stainless steel blade head.







The SECUMAX 350 SE is our sustainable all-rounder. The black handle is made of 98% recycled plastic. The interchangeable 2-in1 robust blade head also gives the knife an extended service life. It can be used for standard cutting materials as well as for more difficult cuts such as thicker film and strapping band. The stainless steel blade makes the safety knife ideal for use in damp conditions.

PRODUCT FEATURES

Technical features

	Maximum safety		Tool-less blade change
	Abrasion resistant		Very ergonomic
	2-cutting edge blade		1 spare blade in knife body
	Cutting depth		For right and left handers
	Lanyard hole		Stainless

Main cutting materials

	Cardboard: up to 2-ply		Wrapping, stretch and shrink foil
	Tape		Plastic strapping band
	Bagged goods		Layers of foil or paper

Installed blade

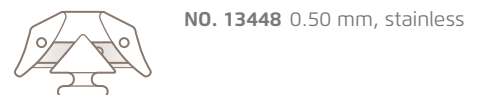

Optional blade



Certificates and awards



Application

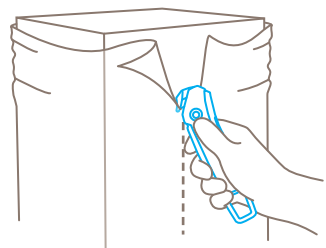
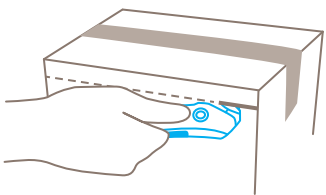
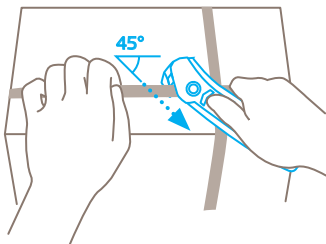

Safety technology

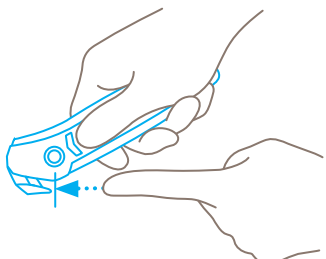

Concealed blade – a maximum degree of safety







The SECUMAX 350 SE blade is not an open one, but is hidden from people and goods. This provides you with a maximum degree of safety from cut injuries and from damage to goods.

YOU CAN FEEL THE QUALITY.

SECUMAX 350 SE

- › Robust, stainless steel blade head
- › Concealed blade
- › Spare blade in storage
- › Handle made of recycled plastic
- › GS-certified for approved safety

PRODUCT DETAILS

Order No.	NO. 350145.02	
Packaging unit	1 in single unit box (10 in multipack)	
Knife size (L x W x H)	152 x 12 x 40 mm	
Main material	Recycled plastic	
Weight	37.0 g	
Cutting depth	6 mm	
Spare blade	NO. 13448.20	
Packaging unit	(10 in box)	
Size (L x W x Thickness)	38.9 x 23.7 x 0.50 mm	
Certified	GS certificate NO. 185136-7655-55094-2022	
Accessories		
BELT HOLSTER S		NO. 9920
BELT HOLSTER XXL		NO. 9924
TOOL RETRACTOR		NO. 9960
CONNECTOR		NO. 9946
USED BLADE CONTAINER		NO. 9810
WALL MOUNT BRACKET USED BLADE CONTAINER		NO. 9845

CONTACT AND SERVICE

What makes our cutting solutions even safer? Our advisory services! We are always on hand, to give advice, to provide you with training material, to meet with you in person if necessary.

You will find further information on our website:
www.martor.com



At a glance: the safety poster shows the most important functions and correct usage – perfect for your workplace.



From the first cut to changing the blade, our video will show you the best way to use this knife.



Everything you want to know: dimensions, properties, special features and more about our cutting tools can be found in the technical data sheet.



Still have questions? You can reach our service department on [+49 212 73870-0](tel:+49212738700)