

SAFETY KNIFE

SECUMAX 145 MDP

ORDER NOW!

Order No.	145007.12
Knife size (L x W x H)	118 x 4 x 35.4 mm
Weight knife	13.7 g
Basic material	Metal detectable plastic



METAL
DETECTABLE

Concealed blade
for maximum protection of
users and goods

2-in-1 blade head
for cutting and
piercing

Metal detectable, ergonomic handle
for optimal detection

4 mm cutting depth
for routine cutting tasks

Guide surfaces
for easier angled cutting

Practical eyelet
for a secure attachment

**2-cutting edge stainless
steel blade (not changeable)**
for a double period of use



THE SAFER WAY TO CUT.

martor

MARTOR SAFETY KNIFE SECUMAX 145 MDP

SAFETY TECHNOLOGY



SECUMAX
= maximum safety

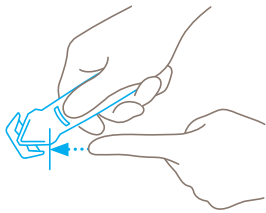

Concealed blade
The SECUMAX 145 MDP blade is not an open one, but is hidden from people and goods. This provides you with a maximum degree of safety from cut injuries and from damage to goods.

TECHNICAL FEATURES



Metal detectable



X-ray detectable



Disposable knife



Ergonomic



2-cutting edge blade



Cutting depth



For right and left handers



Lanyard hole



Stainless

EXAMPLES OF USE



MAIN CUTTING MATERIALS



Cardboard: 1-ply



Wrapping, stretch and shrink foil



Tape



Bagged goods



Layers of foil or paper



Yarn, cord



Plastic strapping band

MOUNTABLE BLADES

The stainless steel blade is moulded into the body of the knife and cannot be changed.
Blade thickness 0.50 mm.

PACKING INFORMATION

Packaging unit	10 in box (loose)
Size Single unit box	124 x 36 x 42 mm
Weight single unit box	151.0 g
EAN Code single unit box	4002632800665