

# SAFETY KNIFE

## SECUMAX 145

ORDER NOW!

Order No.	145001.12
Knife size (L x W x H)	118 x 4 x 35.4 mm
Weight knife	12.0 g
Basic material	Recycled plastic, glass fibre reinforced



MAXIMUM  
SAFETY



**4 mm cutting depth**  
for routine cutting tasks

**Concealed blade**  
for maximum protection  
of users and goods

**2-in-1 blade head**  
for cutting and  
piercing

**Light ergonomic handle**  
for right and left handers



**Guide surfaces**  
for easier diagonal cutting

**Sustainable handle**  
made from at least 60 %  
recycled plastic plus fibreglass  
reinforcement

**2-cutting edge blade  
(not changeable)**  
for a double period of use

THE SAFER WAY TO CUT.

**martor**

# MARTOR SAFETY KNIFE SECUMAX 145



## SAFETY TECHNOLOGY



**SECUMAX**  
= maximum safety

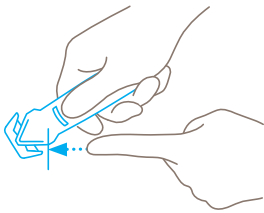

### Concealed blade

The SECUMAX 145 blade is not an open one, but is hidden from people and goods. This provides you with a maximum degree of safety from cut injuries and from damage to goods.

## TECHNICAL FEATURES



Disposable knife



Abrasion resistant



Ergonomic



2-cutting edge blade



Cutting depth



For right and left handers



Lanyard hole



Printable for promotional purposes

## EXAMPLES OF USE



## MAIN CUTTING MATERIALS



Cardboard: 1-ply



Wrapping, stretch and shrink foil



Tape



Bagged goods



Layers of foil or paper



Yarn, cord



Plastic strapping band

## MOUNTABLE BLADES

The blade is moulded into the body of the knife and cannot be changed.  
Blade thickness 0.50 mm.

## PACKING INFORMATION

Packaging unit	10 in box (loose)
Size Single unit box	124 x 36 x 42 mm
Weight single unit box	136.0 g
EAN Code single unit box	4002632800658