

SAFETY POSTER

INSTRUCTIONS FOR THE SAFE HANDLING OF YOUR CUTTING TOOL

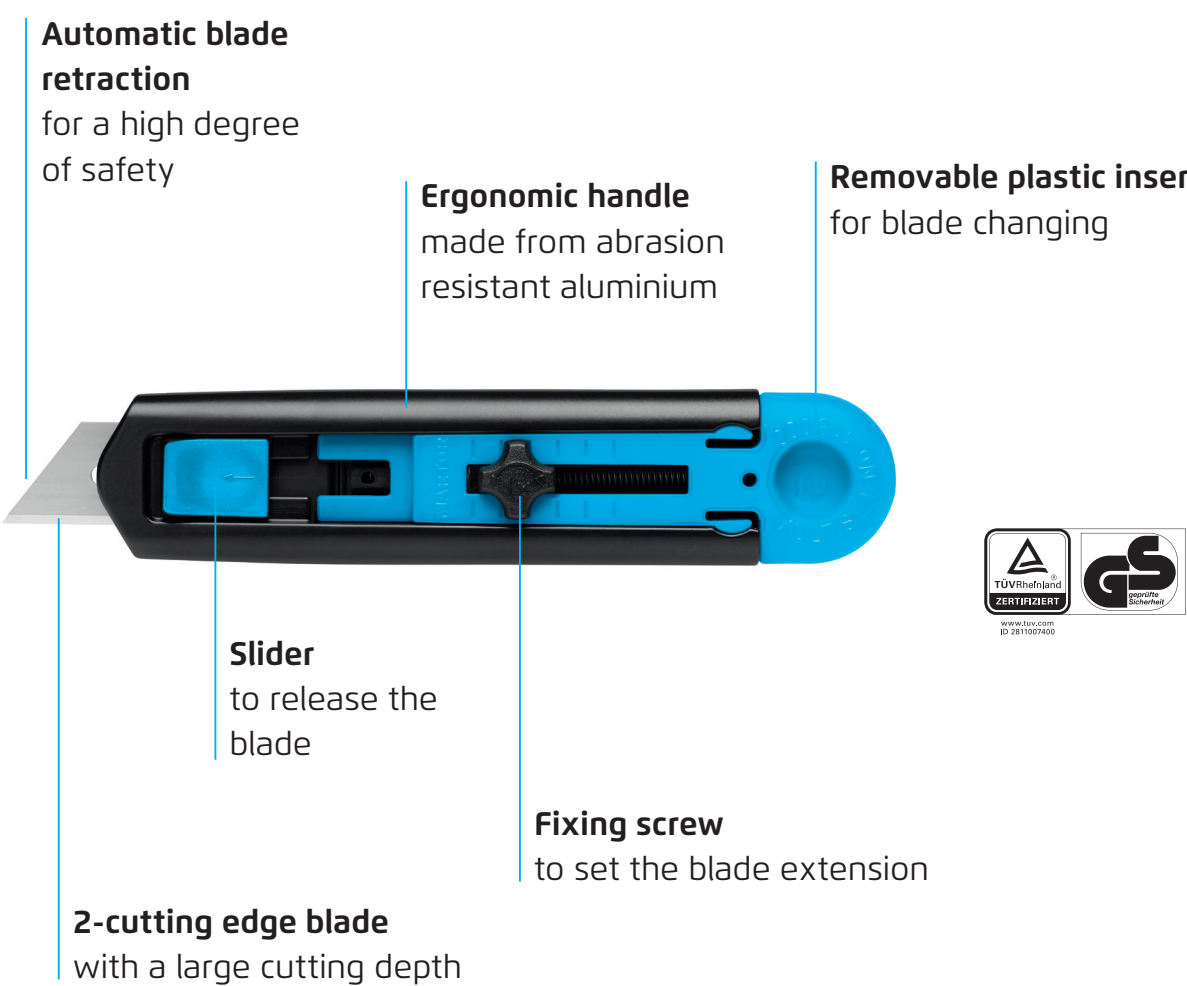

SECUNORM MULTISSET



USAGE

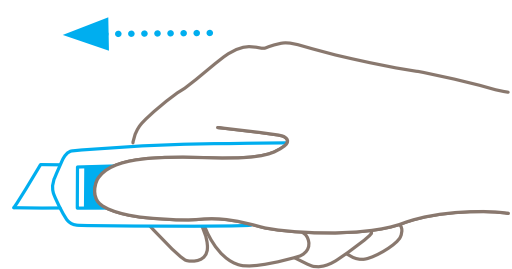

Use the slider to **engage the blade** for cutting.

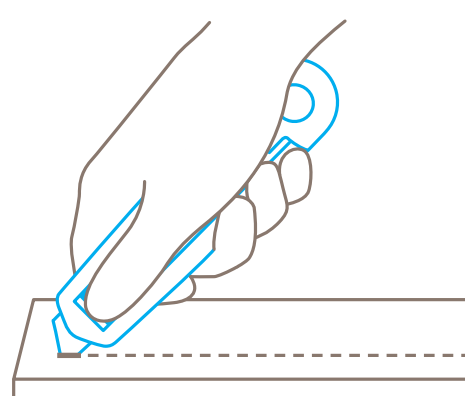

Pierce into the cutting material to cut.

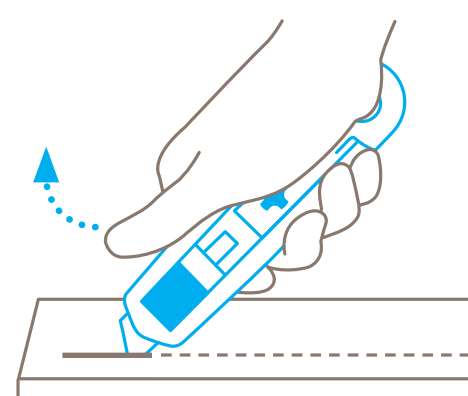

Always remove your **thumb from the slider** to ensure automatic blade retraction.

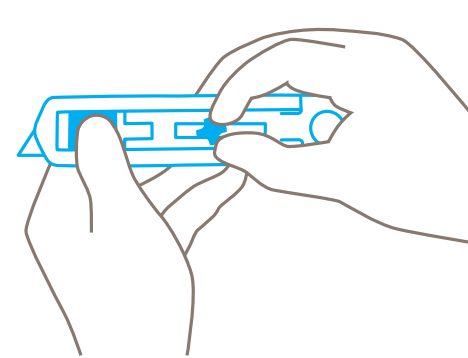

To change the blade extension **loosen locking screw** (by one turn). The further left you fix the screw, the greater the blade extension.

BLADE CHANGE

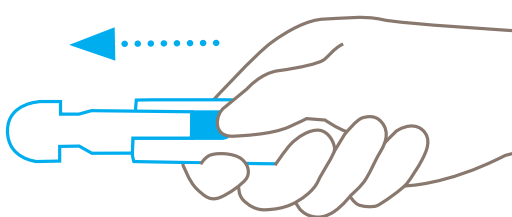

Use the slider to **push** the plastic insert back and out of the handle. Don't pull the insert while holding onto the slider.

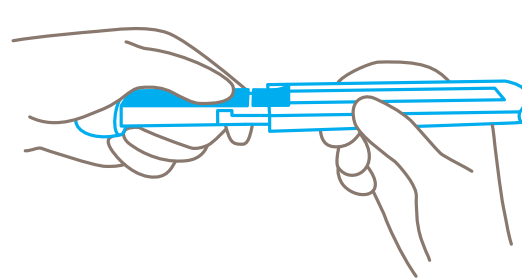

When the slider and blade exits the handle, position your **index finger under the black blade holder** to hold it tight.

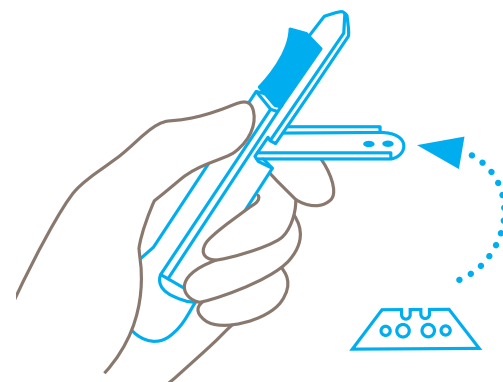

Use your index finger to slowly **fold out the blade holder downwards**. Use the other hand to remove the blade to either replace it or turn it around.

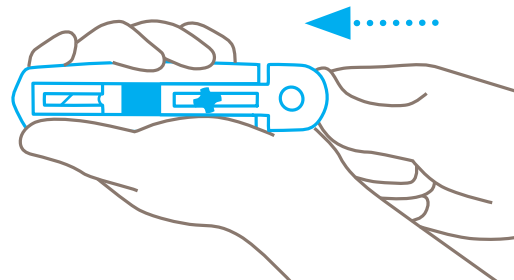

Make sure you position the blade **exactly over the locating lugs**, close the blade holder upwards. **Attention:** Never hold your hand in front of the blade exit!

PROTECTION OF USER

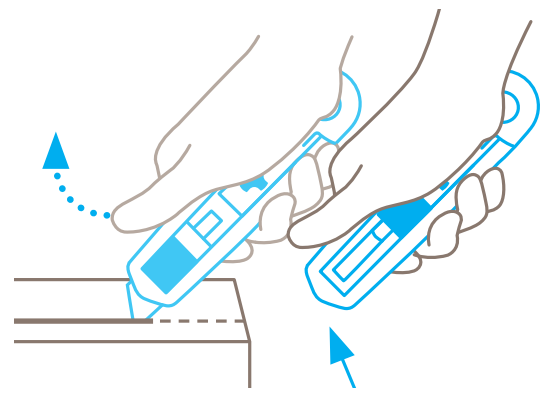

Following cutting, the blade immediately retracts into the handle. Condition: you have **released hold of the slider**.

DISPOSAL

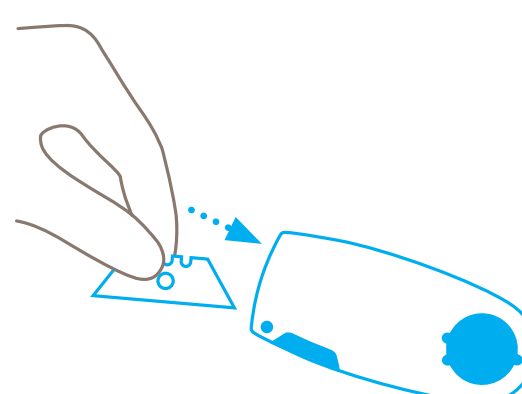

Your **SAFEBOX** is the best place to store **used blades**.

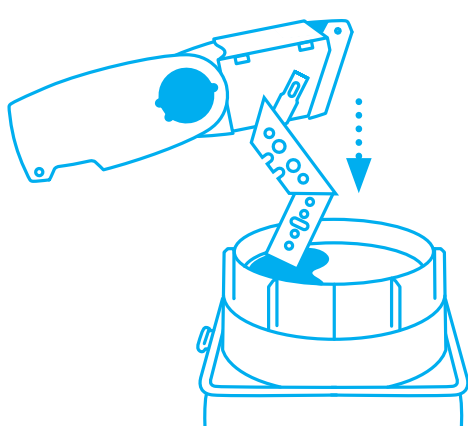

When the **SAFEBOX** is full, **empty all contents** into your **USED BLADE CONTAINER**.

Please note: To ensure your product always functions flawlessly, regularly remove any impurities. For additional safety, we recommend wearing gloves.