

SAFETY POSTER

INSTRUCTIONS FOR THE SAFE HANDLING OF YOUR CUTTING TOOL



SECUNORM MULTISAFE



Please note: To ensure your product always functions flawlessly, regularly remove any impurities. For additional safety, we recommend wearing gloves.

USAGE

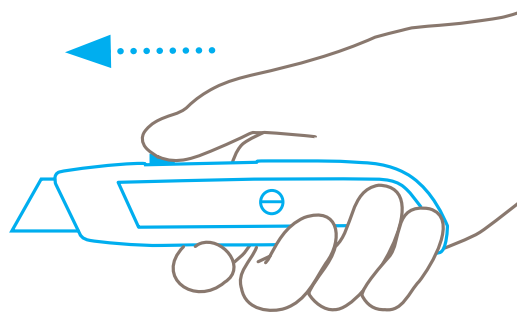

Extend the blade by moving the slider forward.

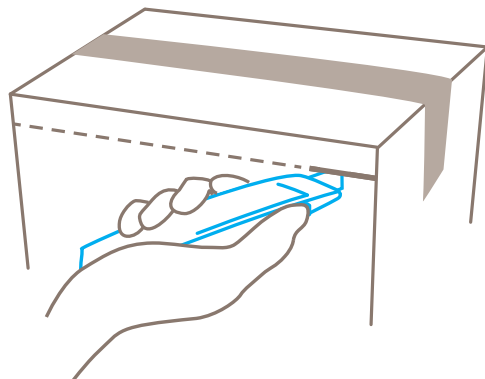

Pierce into the cutting material to cut.

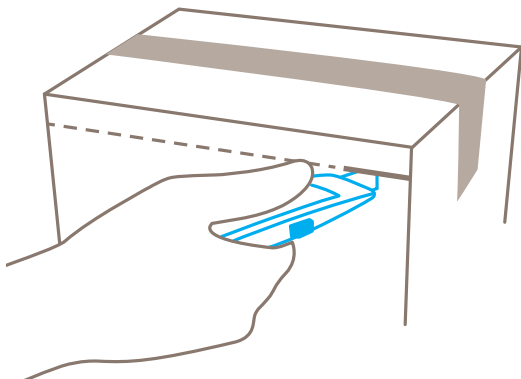

Always remove your **thumb from the slider** to ensure automatic blade retraction.

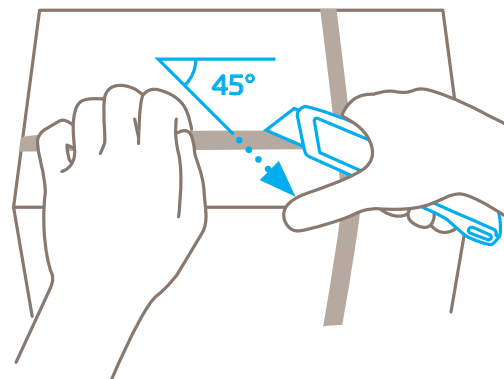

For best results, cut plastic strapping band **diagonally** (at a 45° angle).

BLADE CHANGE

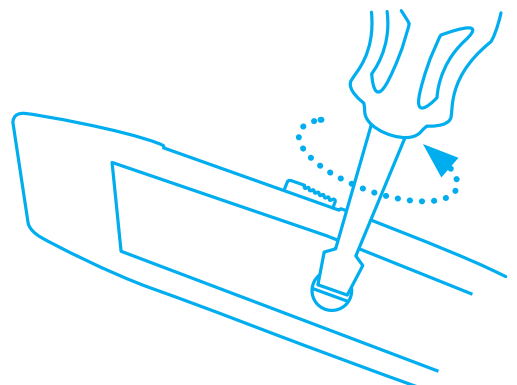

Unscrew the handle and remove the upper half of the handle.

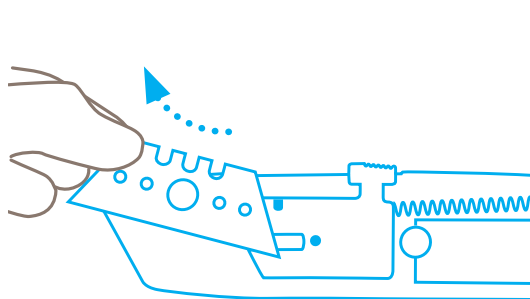

Reverse or replace the blade.

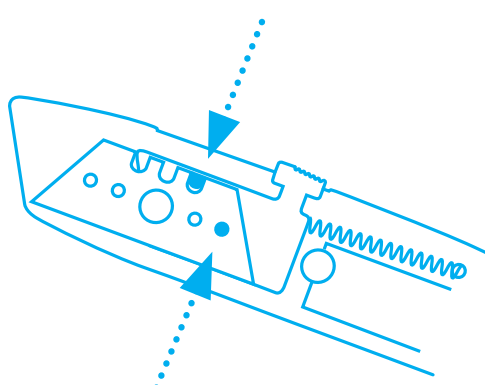

Make sure you place the blade **exactly** on the locating lobe.

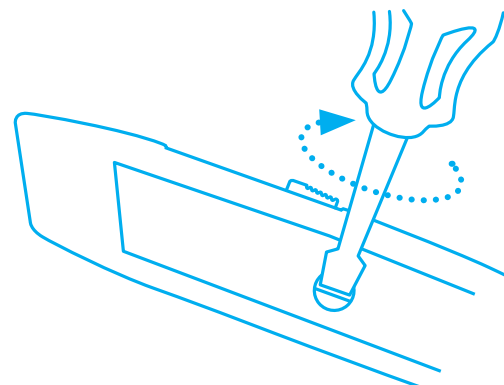

Place the upper half of the handle back on the lower half and fasten the screws **tightly by hand**.

PROTECTION OF USER

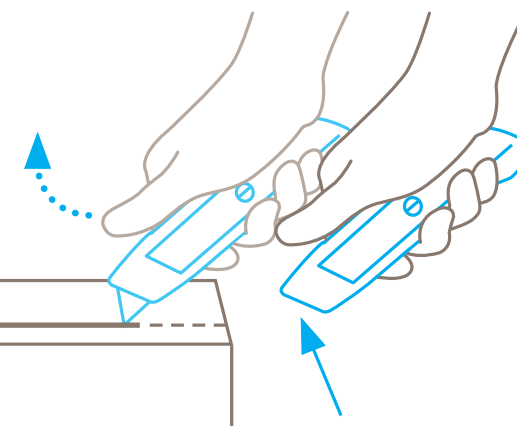

Following cutting, the blade immediately retracts into the handle. Condition: you have **released hold of the slider**.

DISPOSAL

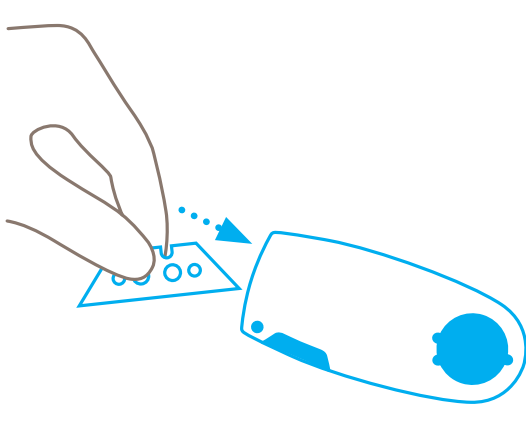

Your SAFEBOX is the best place to store **used blades**.

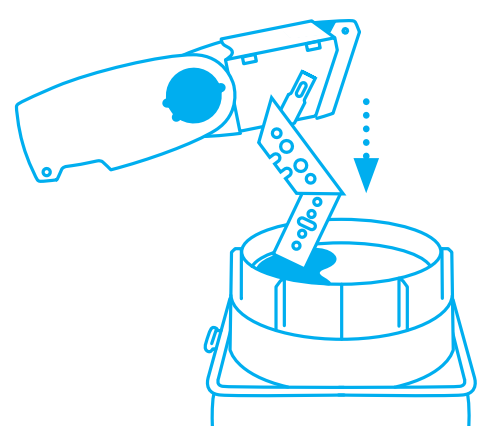

When the SAFEBOX is full, **empty all contents** into your USED BLADE CONTAINER.